

- Roof based on wind condition N2 & AS1684.2-1999  
- It is the builder's responsibility to check the Design & Quantities are correct and sufficient for the requirements of the project.  
- All work to be carried out in accordance with the Building Code of Australia.

100x38 Wesbatten purlins  
End Offset 150mm  
End Spacing 900mm  
Middle Spacing 1200mm

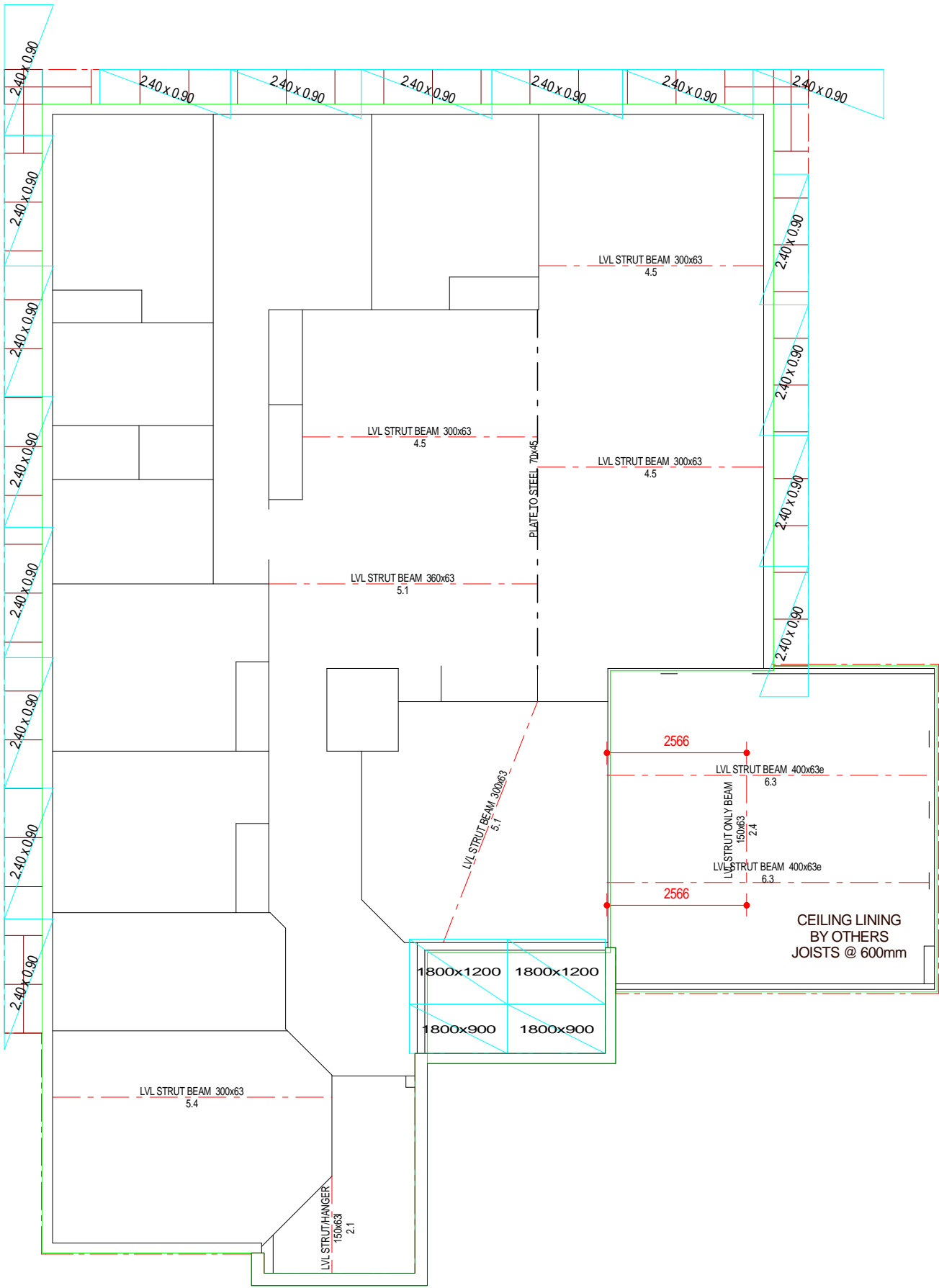

Scale: 1:100  
Sample Roof Cutting List  
Lot

Ability Building Services



Prepared By  
David  
Ph: (08) 9296 8885 Fax: (08) 9296 8895  
File: C:\CAD\DWG\Samples\Samp\_R.SKF

11/11/2010

Rafters @ 900mm Ctrs max U.N.O.  
Pitch 20°49'0" U.N.O.

Gyprock Ceiling Joists @ 600mm Ctrs Max  
4.5mm Hardiflex & WR Gyprock  
Ceiling Joists @ 450mm Ctrs Max

B Barge  
Be Bearer  
Bi Birdboard  
F Fascia  
Fj Floor Joists  
H Hip  
Ha Hanger  
Gs Gable Stud  
Jgb Jarrah Gluelam Beam  
Lvl Laminated Veneer Lumber Hyspan  
(e after LVL size Indicates e-splay LVL)  
Pgb Pine Gluelam Beam  
Pp Pole Plate Bolted  
R Ridge  
Tb Timber Beam  
Up Underpurlin  
V Valley  
Wp Wall Plate